

Date	Rev. date	Work nr.	Drw. nr.	Rev.
Drawn by Ruukki	Rev.	M35/S23-a	-	
Scale 1:3	Building		File nr. P2021/001-00036	

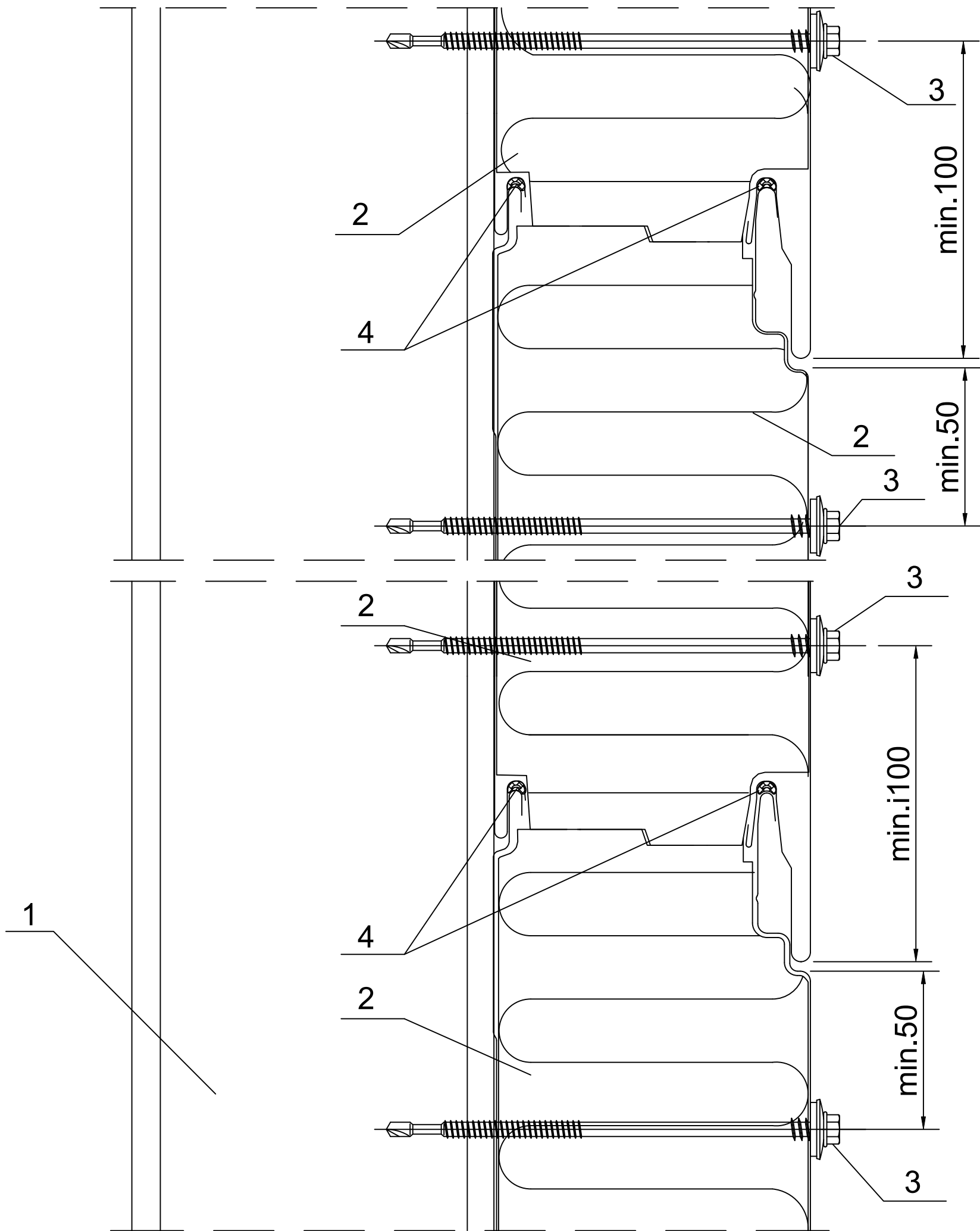

- 1. Steel column acc. to engineering design of the structure.
- 2. Ruukki nSPD WE.
- 3. Panel fastener for hot-rolled steel column or for cold-bentsteel column.
- 4. Butyl sealing compound (to be installed on side) or EPDM gasket (installed during production)

NOTES:  
The insulating core of properly installed panels fits tightly to each other.